

Summer Creek Ranch

Interior Features

- Home isSM Connected-America's Smart HomeSM (See Reverse side for details)
- Matching cabinets throughout the home with 30" upper kitchen cabinets and 36" vanity cabinets in baths (excluding powder baths)
- Ceramic tile flooring at Entry, Hallways (per plan), Kitchen/Breakfast, Family Room, Utility and Bathrooms
- Plush carpet with 3/8" pad
- Cultured marble vanity tops in bathrooms
- Large plate mirrors above bath vanities
- 5' spacious shower in the bath 1
- 5' tub/shower combination in secondary baths
- 6x6 ceramic tile shower surrounds
- Elongated commodes in all baths
- Coordinating lighting package
- Moen® chrome finish plumbing fixtures with lifetime warranty throughout
- Kwikset® brushed nickel interior & exterior door hardware
- Eased corners including window returns
- Wood shelving in all closets, pantry, and utility room for optimal storage use
- Raised panel doors
- Family Room, All Bedrooms and Game Room (per plan) blocked for future ceiling fans
- 4 total drops for phone and/or cable (location per plan)
- Deako switches
- GFI outlets near wet areas of kitchen and baths
- Smoke detector(s) installed per code

Kitchen Features

- Pre-finished 30" painted cabinets with crown molding
- Stainless steel gas appliances (microwave with exterior vented hood, dishwasher & gas range)
- Granite countertops with straight edge
- Ceramic tile backsplash
- Stainless steel drop-in kitchen sinks with garbage disposal
- 4 LED flush mount lights in kitchen ceiling

Exterior Features

- Landscape Package (including full sod front/sides/back)
- Full sprinkler system with rain sensor
- 6' Fully fenced rear yard with metal posts and gate
- Covered Patio (per plan)
- Clay kiln-fired brick with fiber cement exterior siding and trim
- Stone accents per elevation (if applicable)
- 3-tab shingles with 25 yr. manufacture warranty
- Cast stone address plaque
- 6'8" Raised panel front door
- Partial guttering
- Raised panel garage door with decorative hardware

Construction & Energy Features

- High-efficiency 15 SEER 2 air conditioning system with Honeywell Z-Wave™ thermostat
- Gas central heating
- Energy Star construction
- ACCA 310 HV/AC system testing performed by third party
- Square D™ surge protection
- Synthetic roofing underlayment
- Double pane, Low-E, vinyl windows
- R-13 fiberglass insulation in exterior walls
- R-19 insulation at sloped ceilings
- R-38 fiberglass insulation in flat ceiling areas
- R-21 insulation at top plate
- R-21 insulation under HV/AC platform
- Jumper ducts in all secondary bedrooms
- Water shut off valve inside home
- Third party quality inspections for framing
- 10 Year Homebuyer's Warranty
- 2 year limited Mechanical Warranty
- Fully sheetrock and painted garage
- Engineered post-tension 3500 psi foundation
- Poly moisture barrier beneath slab
- Taexx built-in pest control system
- Borate application to protect building materials against wood destroying insects

drhorton.com/texas/fort-worth

D.R. Horton is an Equal Opportunity Builder. Home and community information including pricing, features, terms, and availability are subject to change prior to sale at any time without notice or obligation. Prices, plans, features, and options are subject to change without notice. Additional restrictions may apply. Please check the accuracy of information provided with your Sales Counselor prior to purchasing. Features noted above could be plan specific. Rev. 5.16.23

Home is[®] CONNECTED

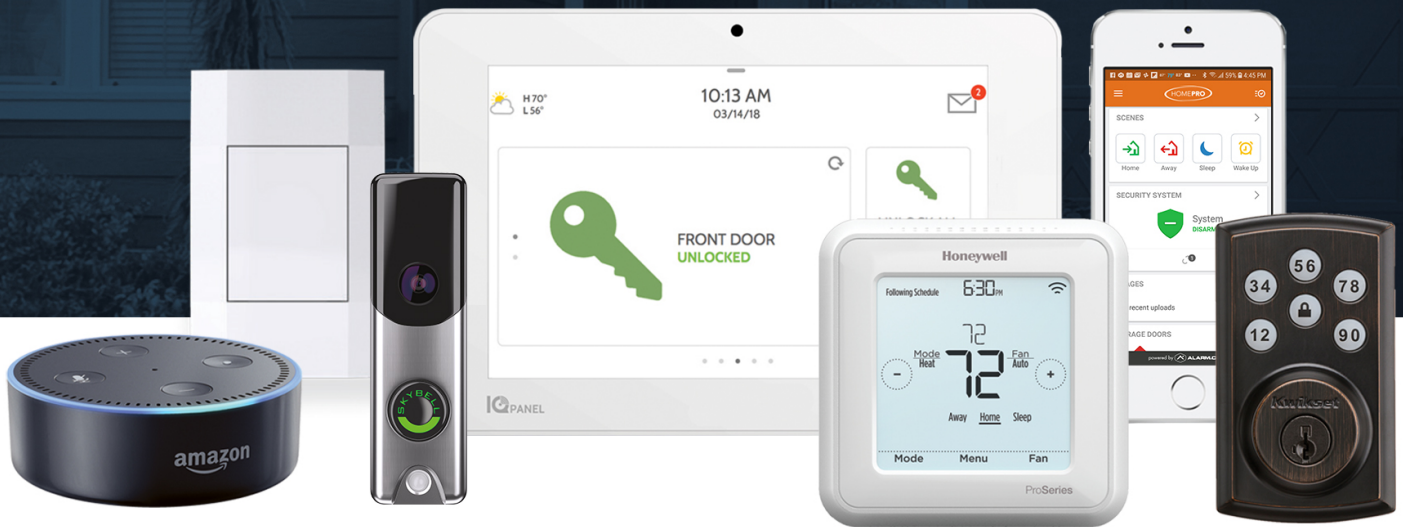

YOU'LL NEVER BE TOO FAR FROM HOME.

Monitor and control your home from your couch or from 500 miles away. Connect to your home with your smartphone, tablet or computer.

HOME LIFE CAN BE HANDS-FREE.

It's never been easier to settle into a new routine. Set the scene with your voice, from your phone, through the Qolsys panel – or schedule it and forget it. Your home will always be there for you.

NO MORE BOXES OF USELESS TECH.

Our priority is to make sure you have the right smart home system to grow with you. Our homes speak to Bluetooth, Wi-Fi, Z-Wave and cellular devices so you can sync with almost any smart device.

D.R. Horton is an Equal Opportunity Builder. A D.R. Horton Smart Home is equipped with technology that includes the following: a Z-Wave programmable thermostat manufactured by Honeywell; a Z-Wave door lock manufactured by Kwikset; a Smart Switch; a Qolsys, Inc. touchscreen Smart Home control device; an automation platform from Alarm.com; a SkyBell video doorbell; and an Amazon Echo Dot. D.R. Horton reserves the right, without prior notice, to substitute other products for those listed above. Other Smart Home technology features may be offered for an additional charge. For Smart Home technology included in the home to work, homeowners must obtain and pay for their own Internet service and may need to purchase compatible devices and to maintain accounts with third parties for the services. D.R. Horton makes no representation or warranty that any or all of the Smart Home technology is secure, will meet any homeowner needs or will provide any level of physical or cyber security for the home – even if the technology is working as intended. All photos and drawings are for illustration purposes only. See a D.R. Horton sales agent for complete information. D.R. Horton is a registered trademark of D.R. Horton Management Company, Ltd. All other trademarks shown are the property of their respective owners. Amazon, Echo, Alexa, and all related logos are trademarks of Amazon.com, Inc. or its affiliates.