

The Parks of Alvarado Grove Series

Interior Features

- Home isSM Connected-America's Smart HomeSM (See Reverse side for details)
- Matching cabinets throughout the home with 30" upper kitchen cabinets and 36" vanity cabinets in baths (excluding powder baths)
- Ceramic tile flooring at Entry, Hallways (per plan), Kitchen/Breakfast, Family Room, Utility and Bathrooms
- Plush carpet with 3/8" pad
- Cultured marble vanity tops in bathrooms
- Large plate mirrors above bath vanities
- 5' spacious shower in the bath 1
- 5' tub/shower combination in secondary baths
- Ceramic tile shower surrounds
- Elongated commodes in all baths
- Coordinating lighting package
- Moen® chrome finish plumbing fixtures with lifetime warranty throughout
- Kwikset® brushed nickel interior & exterior door hardware
- Eased corners including window returns
- Wood shelving in all closets, pantry, and utility room for optimal storage use
- Raised panel doors
- Family Room, all Bedrooms, and Game Room (per plan) blocked for future ceiling fans
- 4 total drops for phone and/or cable (location per plan)
- GFI outlets near wet areas of kitchen and baths
- Smoke detector(s) installed per code
- Toggle light switches

Kitchen Features

- 30" flat panel cabinets with crown molding
- Stainless steel appliances – electric range/oven, dishwasher, microwave (vented to exterior)
- Granite or Quartz countertops with straight edge (per package)
- 4" granite or quartz backsplash (per package)
- Stainless steel undermount kitchen sinks with garbage disposal
- 4 LED flush mount lights in kitchen ceiling

Exterior Features

- Landscape Package (including full sod front/sides/back)
- Full sprinkler system with rain sensor
- 6' Fully fenced rear yard with gate
- Covered Patio (per plan)
- Clay kiln-fired brick or full siding, trim and accents per series & elevation of home
- 3-tab shingles with 25 yr. manufacture warranty
- Address plaque included
- 6'8" Raised panel front door (per series)
- Garage door (style per elevation)
- Coach light (style per elevation)
- Garage door opener
- All exterior siding and trim to be fiber cement

Construction & Energy Features

- High-efficiency 15 SEER heat pump heating/cooling system with Honeywell T6 Pro Z-Wave™ thermostat
- Electric central heating
- Electric hot water heater
- Interior water shut off valve
- Square D™ surge protection
- Synthetic roofing underlayment
- Double pane, Low-E, vinyl windows with Argon gas
- Third party quality inspections for framing
- 10 Year Homebuyer's Warranty
- 2 year limited Mechanical Warranty
- R-13 fiberglass insulation in exterior walls
- R-19 insulation at sloped ceilings
- R-38 fiberglass insulation in flat ceiling areas
- Full sheetrock and painted garage
- Engineered post tension foundation
- All concrete to be 3500 psi
- Poly moisture barrier beneath slab
- Taexx built-in pest control system
- Borate application to protect building materials against wood destroying insects

drhorton.com/texas/fort-worth

D.R. Horton is an Equal Housing Opportunity Builder. Home and community information, including pricing, included features, terms, availability and amenities, are subject to change and prior sale at any time without notice or obligation. Pictures, photographs, colors, features, and sizes are for illustration purposes only and will vary from the homes as built. Square footage dimensions are approximate. Buyer should conduct his or her own investigation of the present and future availability of school districts and school assignments. D.R. Horton has no control or responsibility for any changes to school districts or school assignments should they occur in the future. Revised 11.11.22

Home isSM CONNECTED

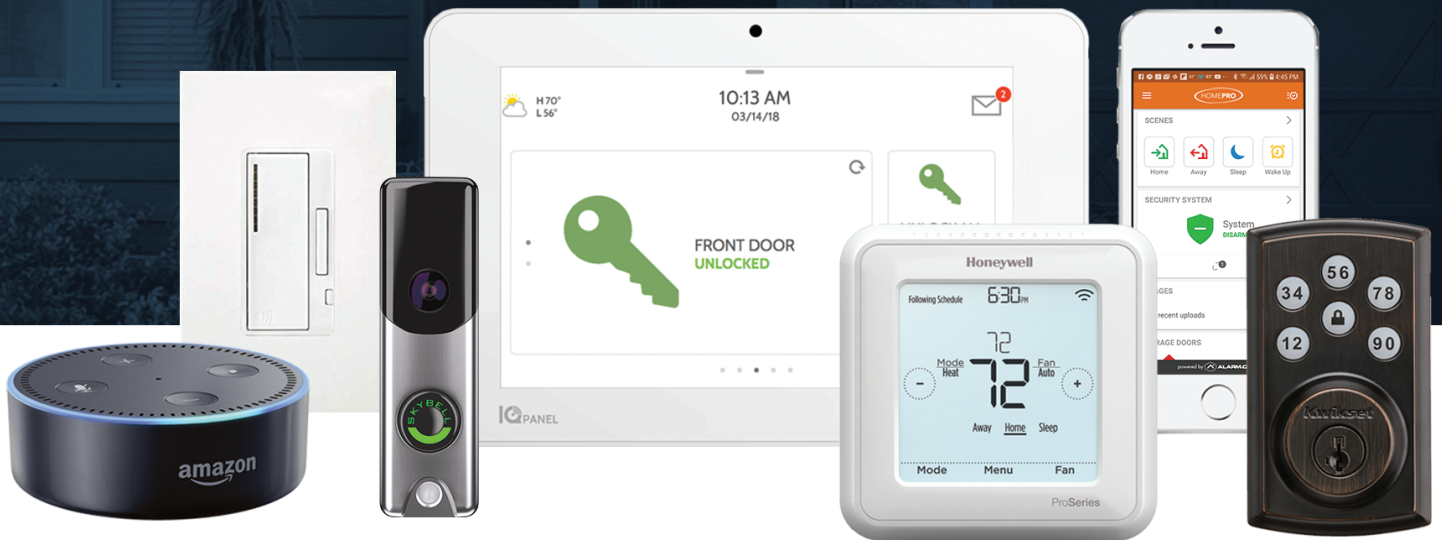

YOU'LL NEVER BE TOO FAR FROM HOME.

Monitor and control your home from your couch or from 500 miles away. Connect to your home with your smartphone, tablet or computer.

HOME LIFE CAN BE HANDS-FREE.

It's never been easier to settle into a new routine. Set the scene with your voice, from your phone, through the Qolsys panel – or schedule it and forget it. Your home will always be there for you.

NO MORE BOXES OF USELESS TECH.

Our priority is to make sure you have the right smart home system to grow with you. Our homes speak to Bluetooth, Wi-Fi, Z-Wave and cellular devices so you can sync with almost any smart device.

D.R. Horton is an Equal Opportunity Builder. A D.R. Horton Smart Home is equipped with technology that includes the following: a Z-Wave programmable thermostat manufactured by Honeywell; a Z-Wave door lock manufactured by Kwikset; a Smart Switch; a Qolsys, Inc. touchscreen Smart Home control device; an automation platform from Alarm.com; a SkyBell video doorbell; and an Amazon Echo Dot. D.R. Horton reserves the right, without prior notice, to substitute other products for those listed above. Other Smart Home technology features may be offered for an additional charge. For Smart Home technology included in the home to work, homeowners must obtain and pay for their own Internet service and may need to purchase compatible devices and to maintain accounts with third parties for the services. D.R. Horton makes no representation or warranty that any or all of the Smart Home technology is secure, will meet any homeowner needs or will provide any level of physical or cyber security for the home – even if the technology is working as intended. All photos and drawings are for illustration purposes only. See a D.R. Horton sales agent for complete information. D.R. Horton is a registered trademark of D.R. Horton Management Company, Ltd. All other trademarks shown are the property of their respective owners. Amazon, Echo, Alexa, and all related logos are trademarks of Amazon.com, Inc. or its affiliates.